



File No. City 22-RI-01: AECOM 60672221
Date February 23, 2022

CITY OF WINNIPEG CONSTRUCTION NOTICE

TO: AIRPORT MOTOR INN - 1800 ELLICE AVENUE

**RE: 2022 LOCAL AND INDUSTRIAL STREET RENEWAL PROGRAM:
BERRY STREET-FROM PORTAGE AVENUE TO ELLICE AVENUE -
PROPOSED NEW SIDEWALK ALONG WESTSIDE PARKING LOT OF 1800 ELLICE
AVENUE**

A street renewal project on Berry Street from Portage Avenue to Ellice Avenue will begin construction in 2022.

As part of this work on Berry Street, we will repair the pavement, sidewalk and curb and install a new asphalt overlay to improve drainage and rideability.

We will also be improving pedestrian accessibility via a new concrete sidewalk along the west side of Berry Street adjacent to your property. To facilitate connecting the sidewalk to Ellice Avenue, we will be removing the portion of pavement that extends from the Airport Inn parking lot onto Berry Street; this is currently in the City of Winnipeg right-of-way.

Attached to this notice is a drawing of the new sidewalk. If you have any questions, please leave a message at (204) 928-8431 and your call will be returned as soon as possible.

Sincerely,

Blair Cockrell
Project Coordinator, Transportation
blair.cockrell@aecom.com

cc: Mr. Naveed Haider, City of Winnipeg, Public Works Department
Ms. Julie Dooley – City of Winnipeg Public Works
Mr. Scott Gillingham – Councillor, St. James
Ms. Debbie Mikulik – City of Winnipeg, Public Works Department, Customer Services
PWD-EngineeringAdmin@winnipeg.ca
311@winnipeg.ca

**For more information on major construction projects:
Visit winnipeg.ca/publicworks or call 311**

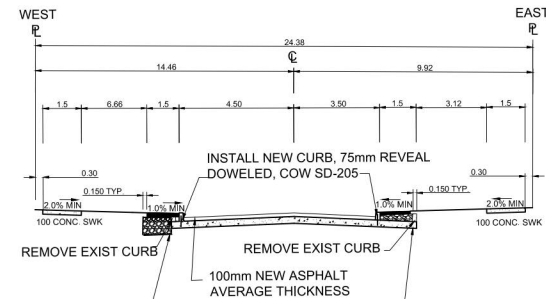
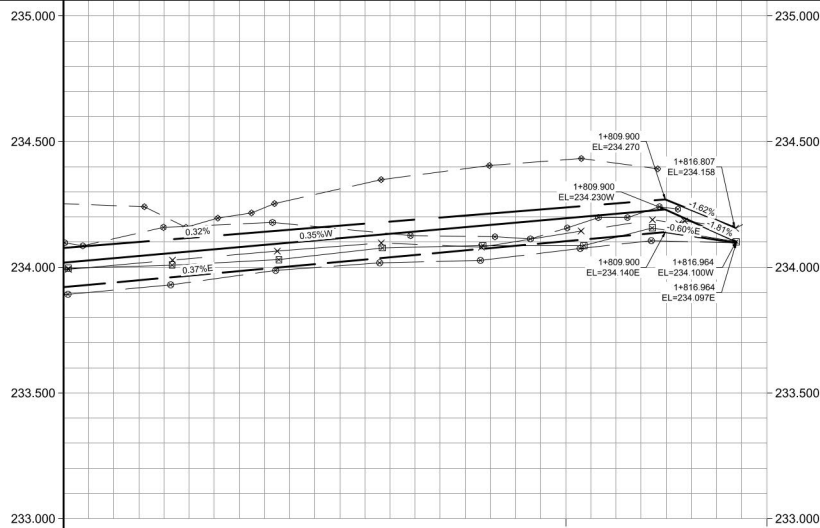

ASPHALT PATH
 75mm ASPHALT PAVEMENT (TYPE 1A)
 125mm - BASE COURSE (GRANULAR A)
 GEOGRID
 150mm - 50mm SUB-BASE (GRANULAR A)
 GEOTEXTILE FABRIC

ASPHALT PATH
 75mm ASPHALT PAVEMENT (TYPE 1A)
 VARIES - BASE COURSE (GRANULAR A)

1
 CT 19
ASPHALT PATH TYPICAL CROSS SECTION-4
 Scale NTS

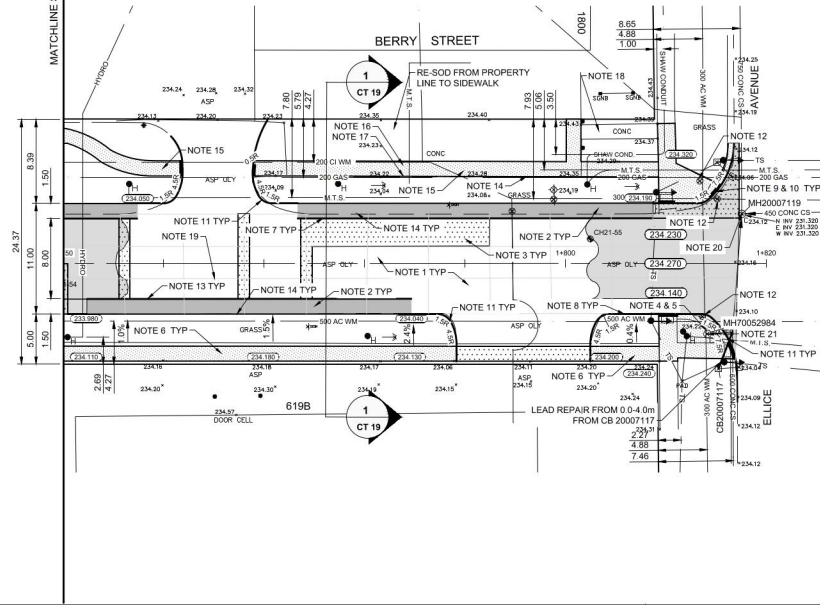

REFERENCE NOTES:

- A. PAVEMENT DIMENSIONS ARE TO BACK OF CURB
- B. BASELINE IS CENTRE LINE ROADWAY
- C. PROPERTY LINES OBTAINED FROM CITY OF WINNIPEG L.B.I.S., AND NO SCALE FACTOR WAS APPLIED
- D. REFER TO AECOM FIELD BOOK NO 5113

CONSTRUCTION NOTES:

1. CONSTRUCT NEW ASPHALT PAVEMENT OVERLAY TYPE 1A (100mm AVG. THICKNESS)
2. CONSTRUCT NEW ASPHALT BIKE PATHWAY PAVEMENT TYPE 1A (75mm THICKNESS) CW COMPACTED 125mm OF LIMESTONE BASE COURSE, GEOGRID, 150mm OF 50mm LIMESTONE SUB-BASE AND SEPARATION/FILTRATION GEOTEXTILE
3. REMOVE EXISTING CONCRETE PAVEMENT AND CONSTRUCT NEW 150mm REINFORCED CONCRETE PAVEMENT
4. ADJUST EXISTING MANHOLE / CATCH BASIN TO GRADE
5. REMOVE EXISTING FRAME AND COVER AND PLACE NEW FRAME AND COVER (AP-006 / AP-007)
6. RENEW EXISTING CONCRETE SIDEWALK
7. INSTALL CONCRETE BARRIER CURB (SEPARATE SD-2034 75mm REVEAL)
8. REMOVE EXISTING BARRIER CURB AND CONSTRUCT NEW CONCRETE BARRIER CURB (75mm REVEAL HT. DOWELED)
9. CONSTRUCT NEW CONCRETE CURB RAMP (10-12mm REVEAL, MONOLITHIC)
10. INSTALL NEW DETECTABLE WARNING TILE
11. REMOVE EXISTING BARRIER CURB AND CONSTRUCT NEW MODIFIED BARRIER CURB (150mm REVEAL HT. DOWELED)
12. ADJUST EXISTING WATER VALVE TO GRADE
13. CONSTRUCT NEW CONCRETE BARRIER CURB (75mm REVEAL HT. DOWELED)
14. REMOVE EXISTING CONCRETE BARRIER CURB
15. CONSTRUCT NEW 100mm CONCRETE SIDEWALK
16. CONSTRUCT NEW BARRIER CURB, DOWELED INTO EXISTING ASPHALT PAVEMENT (150mm REVEAL)
17. REMOVE EXISTING ASPHALT PAVEMENT
18. REMOVE EXISTING CONCRETE SIDEWALK
19. CONTRACT ADMINISTRATOR TO DETERMINE LOCATIONS FOR INSTALLATION OF PAVEMENT REPAIR FABRIC PRIOR TO ASPHALT PAVING
20. MH20007119 - TRIM PROJECTING PIPE AT 0.8m BACK FLUSH TO WALL AND GROUT AROUND PIPE CONNECTIONS AT 0.8m AND 1.8m
21. MH70052984 - REPLACE RISER TO 1.0m

ENGINEERS
INGENIEUR
MANITOBA
 Certificate of Authorization
 AECOM Canada Ltd.
 No. 4671 Date: _____

METRIC
 WHOLE NUMBERS INDICATE MILLIMETRES
 DECIMAL NUMBERS INDICATE METRES

EXISTING	LEGEND - PLAN	PROPOSED	EXISTING	LEGEND - PLAN	PROPOSED	EXISTING	LEGEND - PROFILE	PROPOSED
150mm W.S.	WATERMAIN	150mm W.S.	HYDRO	HYDRO	HYDRO	---	PROFILE	---
Hydrant	HYDRANT	Hydrant	M.T.S.	M.T.S.	M.T.S.	---	WEST GUTTER	---
Valve	VALVE	Valve	CONCRETE	CONCRETE	CONCRETE	---	EAST GUTTER	---
300mm L.D.S.	LAND DRAINAGE SEWER	300mm L.D.S.	ASPHALT	ASPHALT	ASPHALT	---	WEST PROPERTY LINE	---
200mm W.S.	WASTEWATER SEWER	200mm W.S.	PROPERTY LINE	PROPERTY LINE	PROPERTY LINE	---	EAST PROPERTY LINE	---
Manhole	MANHOLE	Manhole	SURVEY BAR	SURVEY BAR	SURVEY BAR	---		---
Catch Basin	CATCH BASIN	Catch Basin	ELEVATION	ELEVATION	ELEVATION	---		---
Catch Pit	CATCH PIT	Catch Pit	TREE	TREE	TREE	---		---
Junctions	JUNCTIONS	Junctions	SIDEWALK RAMP	SIDEWALK RAMP	SIDEWALK RAMP	---		---
Culvert	CULVERT	Culvert	CONCRETE SIDEWALK	CONCRETE SIDEWALK	CONCRETE SIDEWALK	---		---
Gas	GAS	Gas	FENCE	FENCE	FENCE	---		---

LOCATION APPROVED UNDERGROUND STRUCTURES

DATE: _____

NOTE:
 LOCATION OF UNDERGROUND STRUCTURES AS SHOWN ARE BASED ON THE BEST INFORMATION AVAILABLE. BUT NO GUARANTEE IS GIVEN THAT ALL EXISTING UTILITIES ARE SHOWN OR THAT THE GIVEN LOCATIONS ARE EXACT. CONTRIBUTION OF EXISTENCE AND EXACT LOCATION OF ALL SERVICES MUST BE OBTAINED FROM THE INDIVIDUAL UTILITIES BEFORE PROCEEDING WITH CONSTRUCTION.

NO.	REVISIONS	DATE	BY
0	ISSUED FOR TENDER	02/17/2022	BC
A	ISSUED FOR REVIEW	01/28/2022	BC

DESIGNED BY	BC	CHECKED BY	BC/TF
DRAWN BY <td>AA <td>APPROVED BY <td></td> </td></td>	AA <td>APPROVED BY <td></td> </td>	APPROVED BY <td></td>	
HR. SCALE <td>1:250 <td>RELEASED FOR CONSTRUCTION BY: <td></td> </td></td>	1:250 <td>RELEASED FOR CONSTRUCTION BY: <td></td> </td>	RELEASED FOR CONSTRUCTION BY: <td></td>	
VERTICAL: <td>1:10</td> <td>DATE <td>02/17/2022</td> </td>	1:10	DATE <td>02/17/2022</td>	02/17/2022

ENGINEER'S SEAL
 PROVINCE OF MANITOBA
 T.L. FINDLAY
 23820
 REGISTERED PROFESSIONAL ENGINEER

THE CITY OF WINNIPEG
PUBLIC WORKS DEPARTMENT
ENGINEERING DIVISION

2022 LOCAL AND INDUSTRIAL STREET RENEWAL PROGRAM

BERRY STREET - PORTAGE AVENUE TO ELLICE AVENUE ASPHALT PAVEMENT REHABILITATION STATION 1+750 TO ALLICE AVENUE

CITY DRAWING NUMBER
 SHEET 19 OF 19